

Dielectric Filter

- For wireless communication equipment such as base station, repeater etc.
-适用于基站、直放站等无线通信设备。

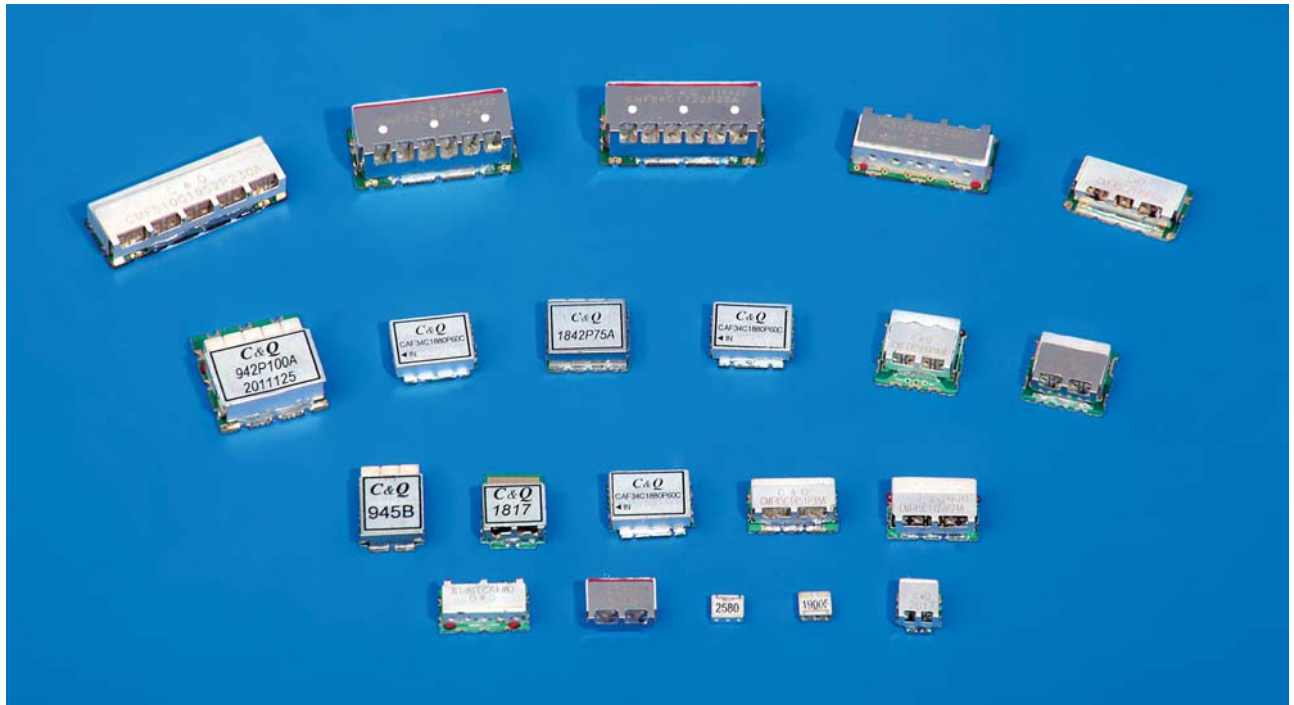

Typical Characteristic (波形特性)

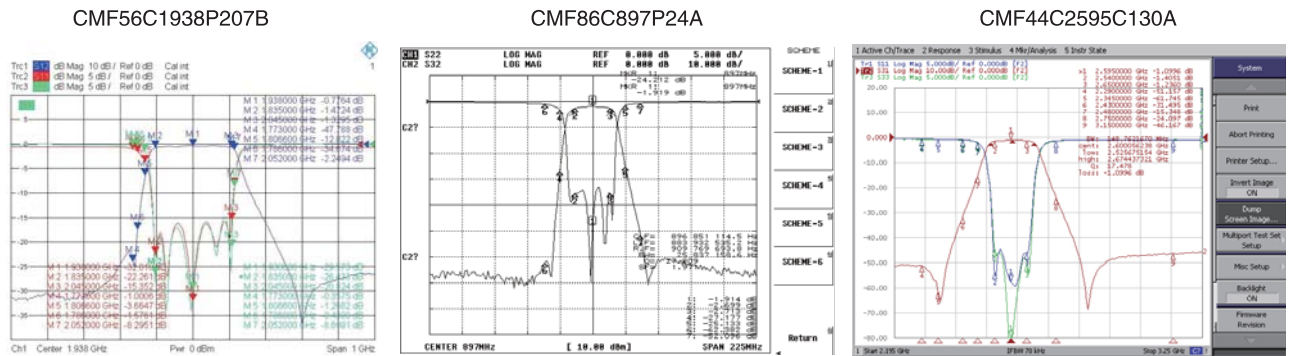

Dimension (尺寸) (Unit:mm)

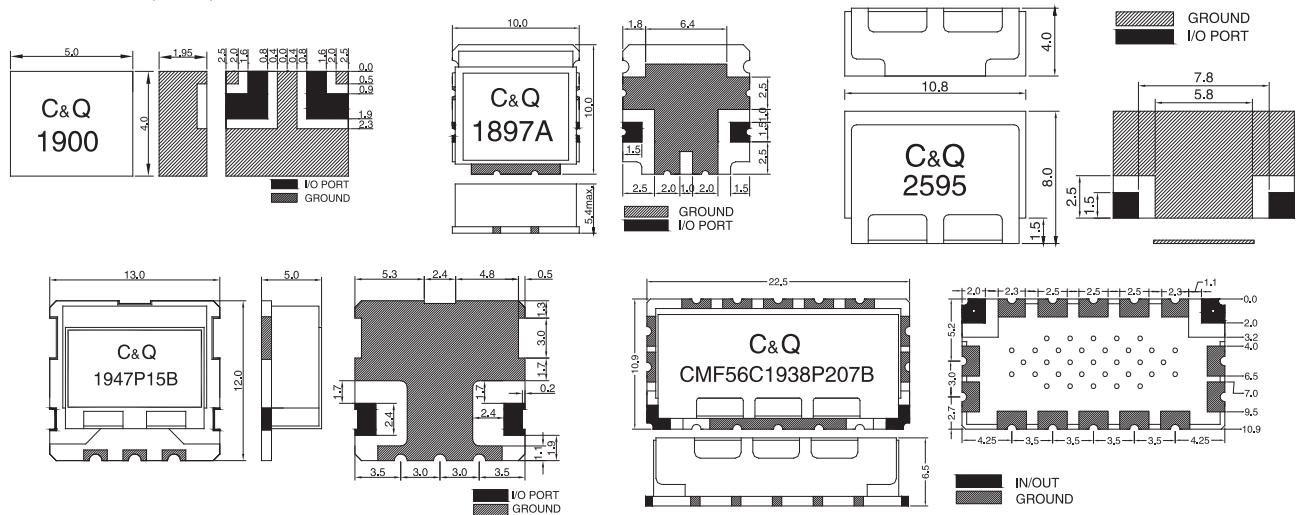

- For wireless communication equipment such as base station, repeater etc.
 -适用于基站、直放站等无线通信设备。

◆ Principal Parameters(主要参数)

| Part No. 型号 | Center Frequency (MHz) 中心频率(f ₀) | Band Width (MHz) min. 带宽 | Insertion Loss (dB) max. 插入损耗 | Ripple in BW (dB) max. 带内波动 | V.S.W.R max 驻波比 | Attenuation (dB) min. (MHz) 衰减 | Dimension W × H × L(max.) (mm) 尺寸 | Application 应用 |
|------------------|--|--------------------------------|-------------------------------------|-----------------------------------|-----------------------|--|--|-------------------|
| CMF43C830S10A | 830.0 | fo ± 5 | 3.5 | 1.0 | 2.0 | 28 at fo ± 40 | 11.9 × 3.9 × 10.4 | CDMA |
| CMF43C875S10A | 875.0 | fo ± 5 | 3.5 | 1.0 | 2.0 | 28 at fo ± 40 | 11.9 × 3.9 × 9.9 | |
| CMF44C827P15A | 827.5 | fo ± 7.5 | 2.5 | 0.5 | 1.5 | 55 at fo ± 45 | 13.0 × 5.0 × 12.0 | |
| CMF44C872P15A | 872.5 | fo ± 7.5 | 2.5 | 0.5 | 1.5 | 55 at fo ± 45 | 13.0 × 5.0 × 12.0 | |
| CMF88C836P25A | 836.5 | fo ± 12.5 | 3.0 | 1.0 | 1.5 | 45 at fo ± 32.5 | 33.4 × 9.0 × 16.0 | |
| CMF88C881P25A | 881.5 | fo ± 12.5 | 3.0 | 1.0 | 1.5 | 45 at fo ± 32.5 | 33.4 × 9.0 × 16.0 | |
| CMF44C900P30A | 900.0 | fo ± 15 | 3.0 | 0.8 | 1.5 | 45 at fo ± 55 | 13.0 × 5.0 × 12.5 | GSM |
| CMF44C945P30A | 945.0 | fo ± 15 | 3.0 | 0.8 | 1.5 | 45 at fo ± 55 | 13.0 × 5.0 × 12.5 | |
| CMF44C902S25A | 902.5 | fo ± 12.5 | 3.0 | 1.0 | 1.5 | 20 at fo ± 32.5 | 15.2 × 3.8 × 7.8 | |
| CMF44C947S25A | 947.5 | fo ± 12.5 | 3.0 | 1.0 | 1.5 | 20 at fo ± 32.5 | 15.2 × 3.8 × 7.5 | |
| CMF45C912P06A | 912.0 | fo ± 3 | 3.5 | 1.0 | 1.5 | 50 at fo ± 100 | 14.0 × 4.5 × 11.5 | |
| CMF45C957P06A | 957.0 | fo ± 3 | 2.5 | 1.0 | 1.5 | 50 at fo ± 100 | 14.0 × 4.5 × 11.5 | |
| CMF86C897P24A | 897.0 | fo ± 12 | 3.0 | 0.8 | 1.5 | 45 at fo ± 30 | 27.0 × 9.0 × 12.0 | W-CDMA |
| CMF86C942P24A | 942.0 | fo ± 12 | 3.0 | 0.8 | 1.5 | 45 at fo ± 30 | 27.0 × 9.0 × 12.0 | |
| CMF56C947C100A | 947.0 | fo ± 50 | 2.0 | 1.0 | 1.5 | 30 at fo ± 100 | 19.0 × 5.2 × 8.8 | |
| CMF53C903P08A | 903.75 | fo ± 3.75 | 3.0 | 1.0 | 1.5 | 20 at fo ± 23 | 14.0 × 6.5 × 11.2 | |
| CMF53C948P08A | 948.75 | fo ± 3.75 | 3.0 | 1.0 | 1.5 | 20 at fo ± 23 | 14.0 × 6.5 × 11.2 | |
| CMF45C1950P60A | 1950.0 | fo ± 30 | 2.5 | 1.0 | 1.5 | 55 at fo ± 160 | 14.0 × 5.0 × 8.0 | |
| CMF45C2140P60A | 2140.0 | fo ± 30 | 2.5 | 1.0 | 1.5 | 55 at fo ± 160 | 14.0 × 5.0 × 8.0 | US-PCS |
| CMF44C1947P15B | 1947.5 | fo ± 7.5 | 2.5 | 0.5 | 1.5 | 50 at fo ± 80 | 13.0 × 5.0 × 12.0 | |
| CMF44C2137P15B | 2137.5 | fo ± 7.5 | 2.5 | 0.5 | 1.5 | 50 at fo ± 80 | 13.0 × 5.0 × 12.0 | |
| CMF44C2140C140A | 2140.0 | fo ± 70 | 3.0 | 1.0 | 1.5 | 20 at fo ± 140 | 10.8 × 4.0 × 9.0 | |
| CMF54C2140S60A | 2140.0 | fo ± 30 | 1.5 | 0.5 | 1.5 | 30 at fo ± 120 | 10.6 × 4.8 × 7.0 | |
| CMF88C1880P60A | 1880.0 | fo ± 30 | 2.5 | 0.6 | 1.5 | 30 at fo ± 70 | 33.4 × 9.0 × 11.5 | |
| CMF88C1960P60A | 1960.0 | fo ± 30 | 2.5 | 0.6 | 1.5 | 30 at fo ± 70 | 33.4 × 9.0 × 11.5 | DCS |
| CMF33C1762S45A | 1762.5 | fo ± 22.5 | 3.0 | 1.0 | 1.5 | 15 at fo ± 72.5 | 8.5 × 3.0 × 7.2 | |
| CMF33C1857S45A | 1857.5 | fo ± 22.5 | 3.0 | 1.0 | 1.5 | 15 at fo ± 72.5 | 8.5 × 3.0 × 6.9 | |
| CMF44C1722P25A | 1722.5 | fo ± 12.5 | 2.0 | 0.5 | 1.5 | 15 at fo ± 95 | 13.0 × 5.0 × 12.0 | |
| CMF44C1817P25A | 1817.5 | fo ± 12.5 | 2.0 | 0.5 | 1.5 | 15 at fo ± 95 | 13.0 × 5.0 × 12.0 | |
| CMF45C1732P45A | 1732.5 | fo ± 22.5 | 3.0 | 1.0 | 1.5 | 40 at fo ± 70 | 14.5 × 5.0 × 8.0 | |
| CMF45C1827P45A | 1827.5 | fo ± 22.5 | 3.0 | 1.0 | 1.5 | 40 at fo ± 70 | 14.5 × 5.0 × 8.0 | TD-SCDMA LTE |
| CMF810C1747P75A | 1747.5 | fo ± 37.5 | 3.3 | 1.5 | 1.5 | 45 at 1842.5 | 43.5 × 9.5 × 13.0 | |
| CMF810C1842P75A | 1842.5 | fo ± 37.5 | 3.3 | 1.5 | 1.5 | 45 at 1747.5 | 43.5 × 9.5 × 13.0 | |
| CMF43C2017S15D | 2017.5 | fo ± 7.5 | 3.0 | 0.5 | 1.5 | 40 at fo ± 97.5 | 11.8 × 3.8 × 6.5 | |
| CMF44C2017P60A | 2017.5 | fo ± 30 | 2.0 | 0.5 | 1.5 | 30 at fo ± 100 | 10.0 × 4.6 × 10.0 | |
| CMF45C2017P15A | 2017.5 | fo ± 7.5 | 3.5 | 1.0 | 1.5 | 50 at fo ± 55.5 | 14.5 × 5.0 × 8.0 | |
| CMF23C2017S77A | 2017.5 | fo ± 38.5 | 2.3 | 0.9 | 2.0 | 38 at 1~1720 27 at 1720~1880 18 at 2170~2200 | 5.0 × 1.8 × 4.0 | MMDS |
| CMF33C2017S77A | 2017.5 | fo ± 38.5 | 2.3 | 0.9 | 2.0 | 38 at 1~1720 27 at 1720~1880 26 at 2170~2200 | 6.0 × 3.0 × 5.8 | |
| CMF34C2017T60A | 2017.5 | fo ± 30 | 2.5 | 1.0 | 1.5 | 30 at 1850 15 at 1956 & 2078 | 9.0 × 3.0 × 5.5 | |
| CMF23C1900F120B | 1900.0 | fo ± 60 | 2.3 | 0.9 | 2.0 | 40 at 1710~1745 25 at 1745~1780 | 5.0 × 1.8 × 4.0 | |
| CMF23C1900F120C | 1900.0 | fo ± 60 | 2.3 | 0.7 | 2.0 | 35 at 1710~1745 20 at 1745~1780 | 5.0 × 1.8 × 4.0 | |
| CMF23C2345F130A | 2345.0 | fo ± 65 | 3.0 | 1.0 | 1.5 | 30 at fo ± 165 | 5.0 × 1.8 × 4.0 | |
| CMF23C2350F180A | 2350.0 | fo ± 90 | 2.5 | 1.0 | 1.5 | 45 at fo ± 320 | 5.0 × 1.8 × 4.0 | |
| CMF23C2580F220A | 2580.0 | fo ± 110 | 3.0 | 1.2 | 1.5 | 15 at fo ± 180 | 5.0 × 1.8 × 4.0 | |
| CMF23C2597F125A | 2597.0 | fo ± 62.5 | 2.3 | 1.0 | 1.5 | 25 at fo ± 240 | 5.0 × 1.8 × 4.0 | |
| CMF43C2595C50B | 2595.0 | fo ± 25 | 2.5 | 1.0 | 1.5 | 40 at fo ± 175 | 9.2 × 4.2 × 7.5 | |
| CMF43C2600C200A | 2600.0 | fo ± 100 | 2.5 | 1.0 | 1.5 | 30 at fo ± 240 | 9.2 × 4.2 × 6.5 | |
| CMF44C2345P180A | 2345.0 | fo ± 90 | 1.6 | 0.7 | 1.5 | 45 at fo ± 200 | 10.0 × 5 × 10.0 | |
| CMF44C2582C75A | 2582.0 | fo ± 37.5 | 2.5 | 1.0 | 1.5 | 30 at fo ± 150 | 10.8 × 4 × 8.0 | |
| CMF44C2595C130A | 2595.0 | fo ± 65 | 2.5 | 1.0 | 1.5 | 60 at fo ± 250 | 10.8 × 4 × 8.0 | |
| CMF45C2345P130A | 2345.0 | fo ± 65 | 3.0 | 1.0 | 1.5 | 35 at fo ± 165 | 10.0 × 5 × 10.0 | |
| CMF45C1897P100A | 1897.0 | fo ± 50 | 3.0 | 1.5 | 1.4 | 30 at fo ± 175 | 10.0 × 5 × 10.0 | |
| CMF45C2017P94A | 2017.5 | fo ± 47.0 | 3.0 | 1.5 | 1.5 | 35 at fo ± 175 | 10.0 × 5 × 10.0 | |
| CMF56C1938P207B | 1938.0 | fo ± 103.5 | 3.0 | 1.2 | 1.5 | 45 at fo ± 165 | 22.5 × 6.5 × 11.0 | |
| CMF54C2655S70A | 2655.0 | fo ± 35 | 1.5 | 0.5 | 1.5 | 13 at fo ± 105 | 10.6 × 4.8 × 6.0 | |
| CMF54C2017S15A | 2017.5 | fo ± 7.5 | 1.5 | 0.5 | 1.5 | 18 at fo ± 75 | 11.7 × 4.8 × 6.0 | |
| CMF54C1900S40A | 1900.0 | fo ± 20 | 1.9 | 1.0 | 1.5 | 18 at fo ± 50 | 11.7 × 4.8 × 6.0 | |
| CMF54C1897S35A | 1897.5 | fo ± 17.5 | 1.5 | 0.5 | 1.5 | 15 at fo ± 65 | 11.7 × 4.8 × 6.2 | |
| CMF35C2350F300A | 2350.0 | fo ± 150 | 2.0 | 1.5 | 1.5 | 25 at fo ± 250 | 22.5 × 6.5 × 11.0 | |
| CMF46C2350C100A | 2350.0 | fo ± 50 | 2.0 | 1.0 | 1.5 | 40 at fo ± 100 | 16.0 × 4.3 × 7.7 | |
| CMF48C2655C150A | 2655.0 | fo ± 75 | 3.2 | 1.5 | 1.5 | 20 at fo ± 95 | 18.5 × 4.2 × 7.2 | |
| CMF510C1952P230A | 1952.0 | fo ± 115 | 3.5 | 2.5 | 1.8 | 20 at fo ± 140 | 30.0 × 6.0 × 10.0 | |
| CMF33C3462S27A | 3462.5 | fo ± 13.5 | 3.0 | 1.0 | 1.5 | 15 at fo ± 86 | 8.2 × 3.0 × 7.5 | |
| CMF33C3562S27A | 3562.5 | fo ± 13.5 | 3.0 | 1.0 | 1.5 | 15 at fo ± 86 | 8.2 × 3.0 × 7.2 | |
| CMF33C3450S100A | 3450.0 | fo ± 50.0 | 2.3 | 1.0 | 1.5 | 12 at fo ± 150 | 8.2 × 3.0 × 4.5 | |
| CMF33C3550S100A | 3550.0 | fo ± 50.0 | 2.3 | 1.0 | 1.5 | 15 at fo ± 150 | 8.2 × 3.0 × 4.5 | |

Note: The data for reference only, Design it as customer's request. 以上参数仅作参考，可根据用户要求设计。

Dielectric Filter\Duplexer\Multiplexer\Coupler

◆FEATURES

- Various Size & Wide Frequency
- Temperature Compensated
- Low Insertion Loss
- High frequency selectivity

◆特点

- 多种尺寸、频率范围广
- 温度补偿
- 低插损
- 高频率选择性

◆APPLICATIONS

- Base Station
- Repeater
- Cellular phone
- Cordless phone
- Trunked Radio System(TRS)
- PCS
- DECT
- Radar, Electronic counterwork
- Aviation and Spaceflight, Navigation
- Wireless LAN
- MMDS
- CDMA
- IMT-2000
- GSM
- DCS

◆应用

- 通信基站
- 通信转发器
- 蜂窝式电话
- 无绳电话
- 中继无线系统
- 个人移动通信系统
- 数字无绳电话
- 雷达、电子对抗
- 军事、航空航天等领域
- 无线局域网
- 多重频道, 多重定位系统
- 码分多路访问(通信)
- 国际移动通讯
- 全球数字移动电话系统
- 无线局域网

Method of Definition (命名方式)

C □ □ □ □ □ □ □ □ □ □
① ② ③ ④ ⑤ ⑥ ⑦ ⑧ ⑨ ⑩

- ① C&Q
- ② M: Mono Type A: Array Type
- ③ F: Filter D: Duplexer
- ④ Thickness
- ⑤ Number of resonator
- ⑥ Hole Structure
- ⑦ Center Frequency
- ⑧ Connect type S: SMD C: SMD+Case P: SMD+Case+PCB
- ⑨ Bandwidth
- ⑩ Versions

- ① C&Q
- ② M: 连体式 A: 分立式
- ③ F: 滤波器 D: 双工器
- ④ 厚度
- ⑤ 腔体数
- ⑥ 结构形式
- ⑦ 中心频率
- ⑧ 封装形式
- ⑨ 带宽
- ⑩ 版本

C □ □ □ □ □ □ □ □ □ □
① ② ③ ④ ⑤ ⑥ ⑦ ⑧ ⑨ ⑩

- ① C&Q
- ② DCF: MCF: MUF: DBF:
- ③ Number of filter or duplexer
- ④ Specification
- ⑤ Hole Structure
- ⑦ Center Frequency
- ⑧ Connect type S: SMD C: SMD+Case P: SMD+Case+PCB
- ⑨ Bandwidth
- ⑩ Versions

- ① C&Q
- ② 双工耦合器: 多工耦合器: 多工器: 双频滤波器
- ③ 滤波器或双工器个数
- ④ 滤波器规格
- ⑥ 结构形式
- ⑦ 中心频率
- ⑧ L: 针插式 H: 金属外壳
- ⑨ 带宽
- ⑩ 版本

回流焊温度曲线
Reflow profile

